

Stepping Motors

M49SP-2K

OUTLINE

A standard model in $\phi 49$ series.
 Uses MITSUMI's original structure of 4-layer stator.
 It realizes high-output torque and high efficiency.



FEATURES

1. MITSUMI's original torque characteristics.
2. Superior running quietness and stability.

USES

Printers, multifunction machines, copy machines, FAX, etc.

SPECIFICATIONS

Item	49SP-2K
Rated Voltage	DC 24V
Working Voltage	DC 21.6~26.4V
Rated Current/Phase	1A(PEAK)
No. of Phase	2 Phase
Coil DC Resistance	4.6Ω/phase±7%
Step Angle	7.5°/step
Excitation Method	2-2 Phase excitation (Bipolar driving)
Insulation Class	Class E insulation
Holding Torque	134mN·m
Pull-out Torque	100mN·m/1,100pps
Pull-in Torque	102mN·m/250pps
Max. Pull-out Pulse Rate	2,150pps
Max. Pull-in Pulse Rate	430pps

CHARACTERISTICS

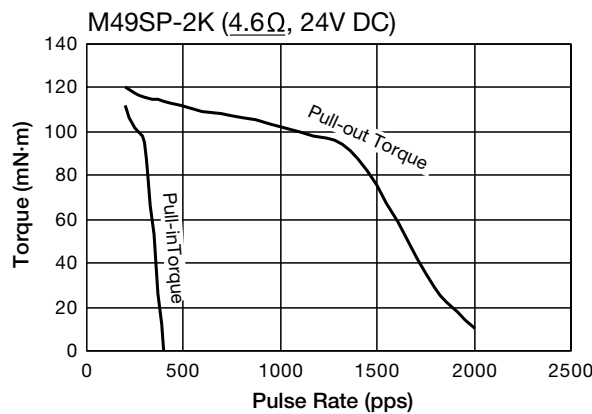

DIMENSIONS

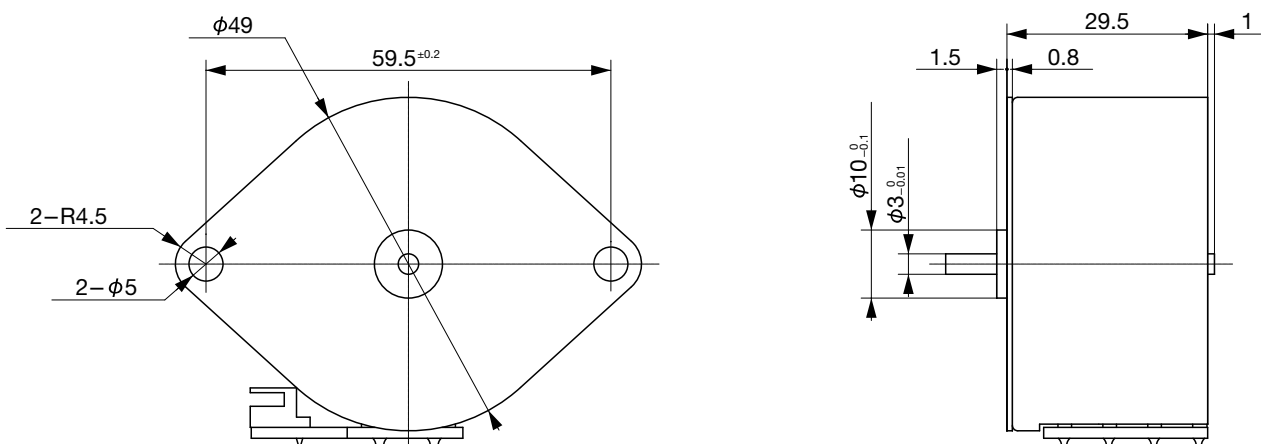

Unit : mm, General tolerance : ±0.5