

Disabling Driver Signature on Windows 10

in [Obsolete](#) /

PlanetCNC Drivers are now signed. This tutorial no longer applies!

Select “Settings” from the Start Menu:



Select the “Update & recovery” option:

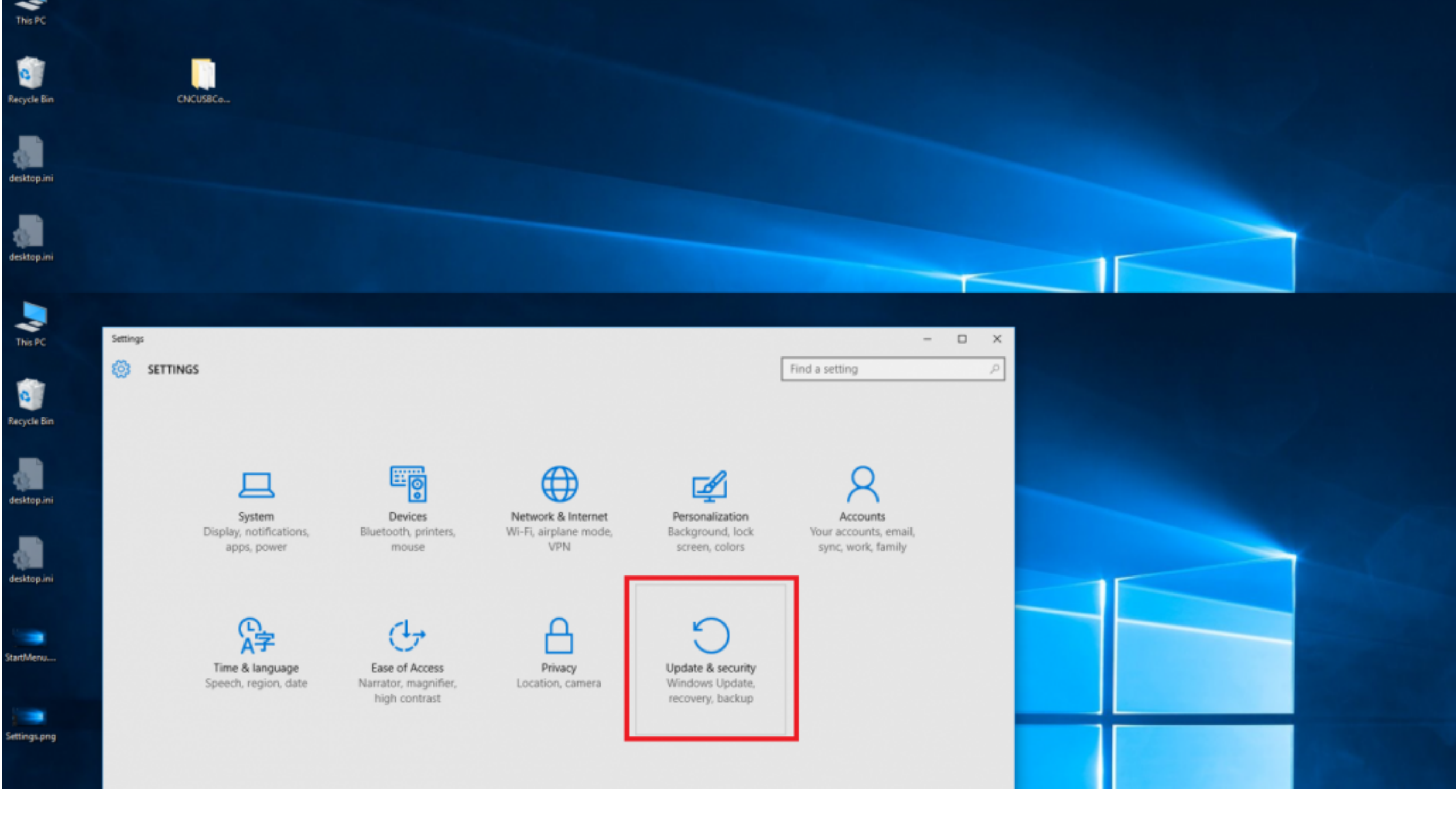

Then click on the Recovery option on the left hand side, and once selected, you will see an advanced startup section appear on the right hand side. You will need to click on the “Restart now” button.

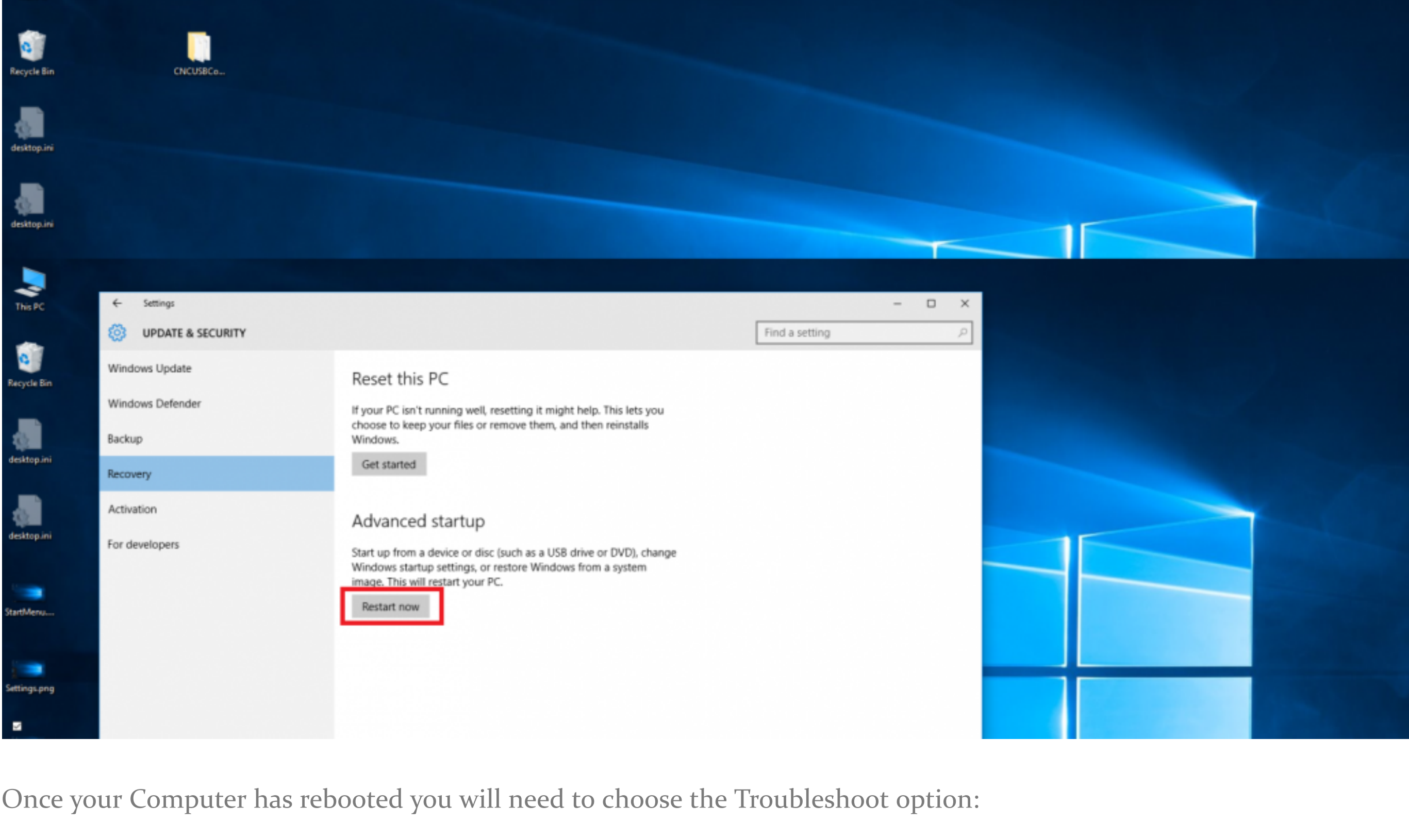

Once your Computer has rebooted you will need to choose the Troubleshoot option:



Click Advanced options:

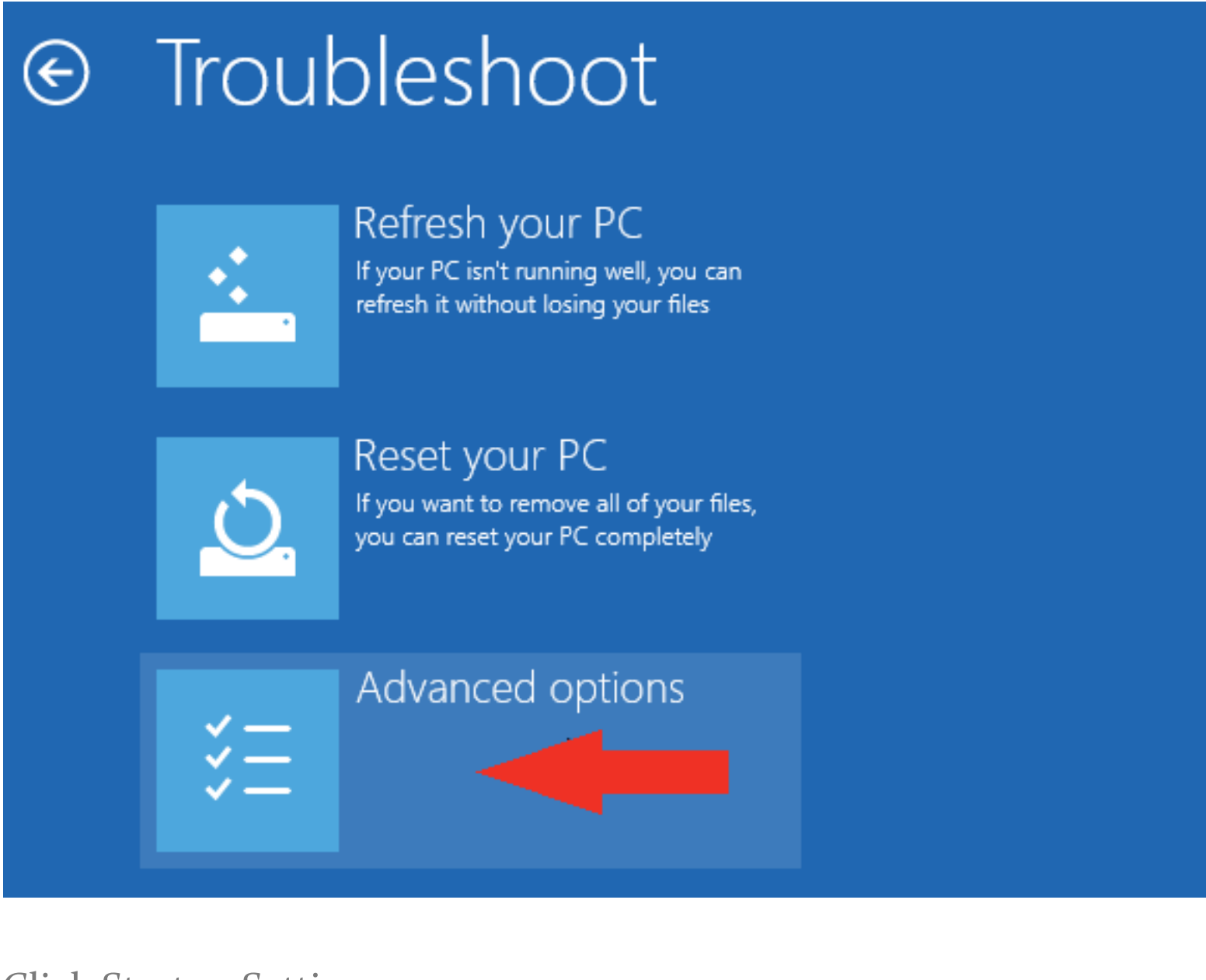

Click Startup Settings:

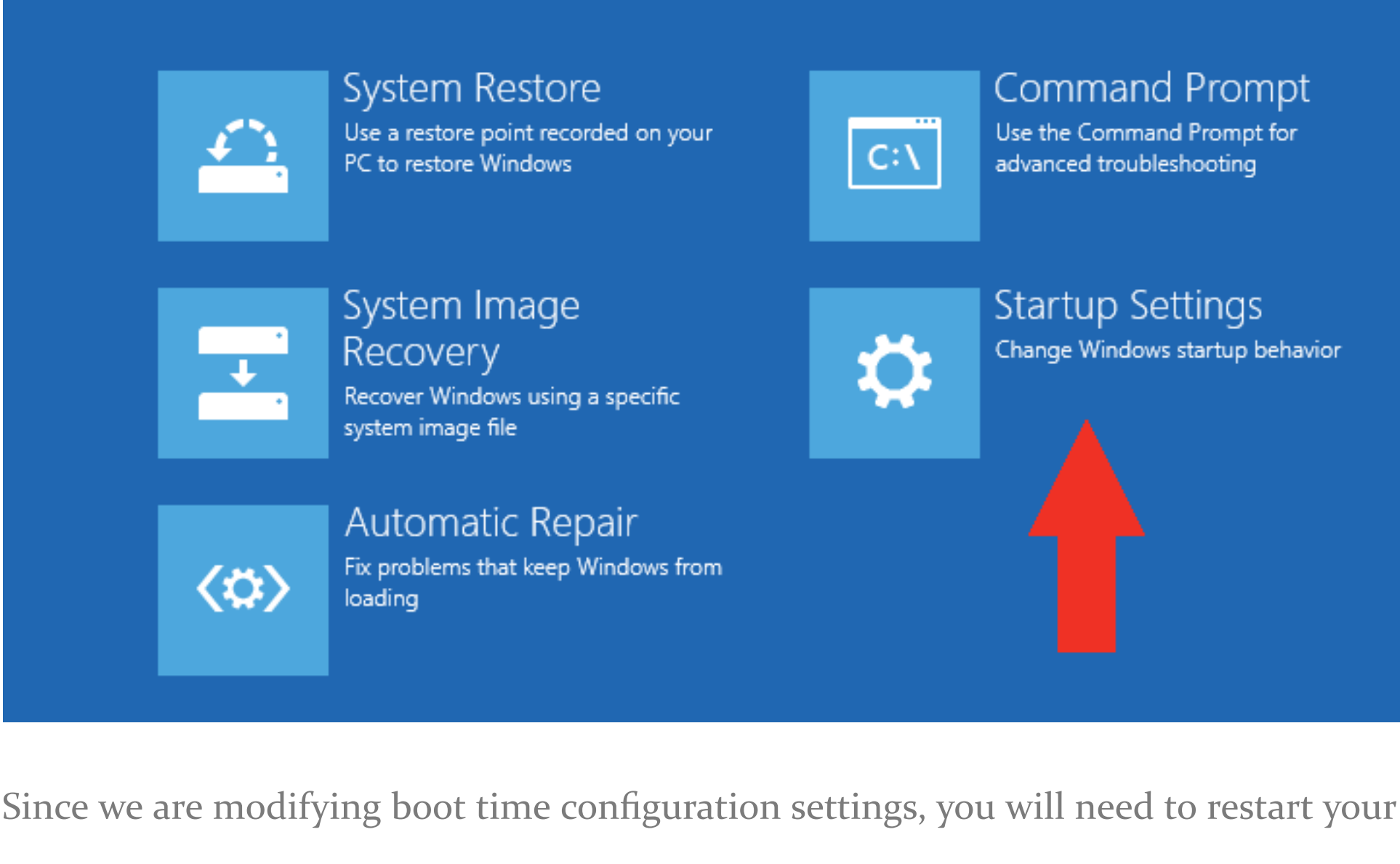

Since we are modifying boot time configuration settings, you will need to restart your computer one last time:

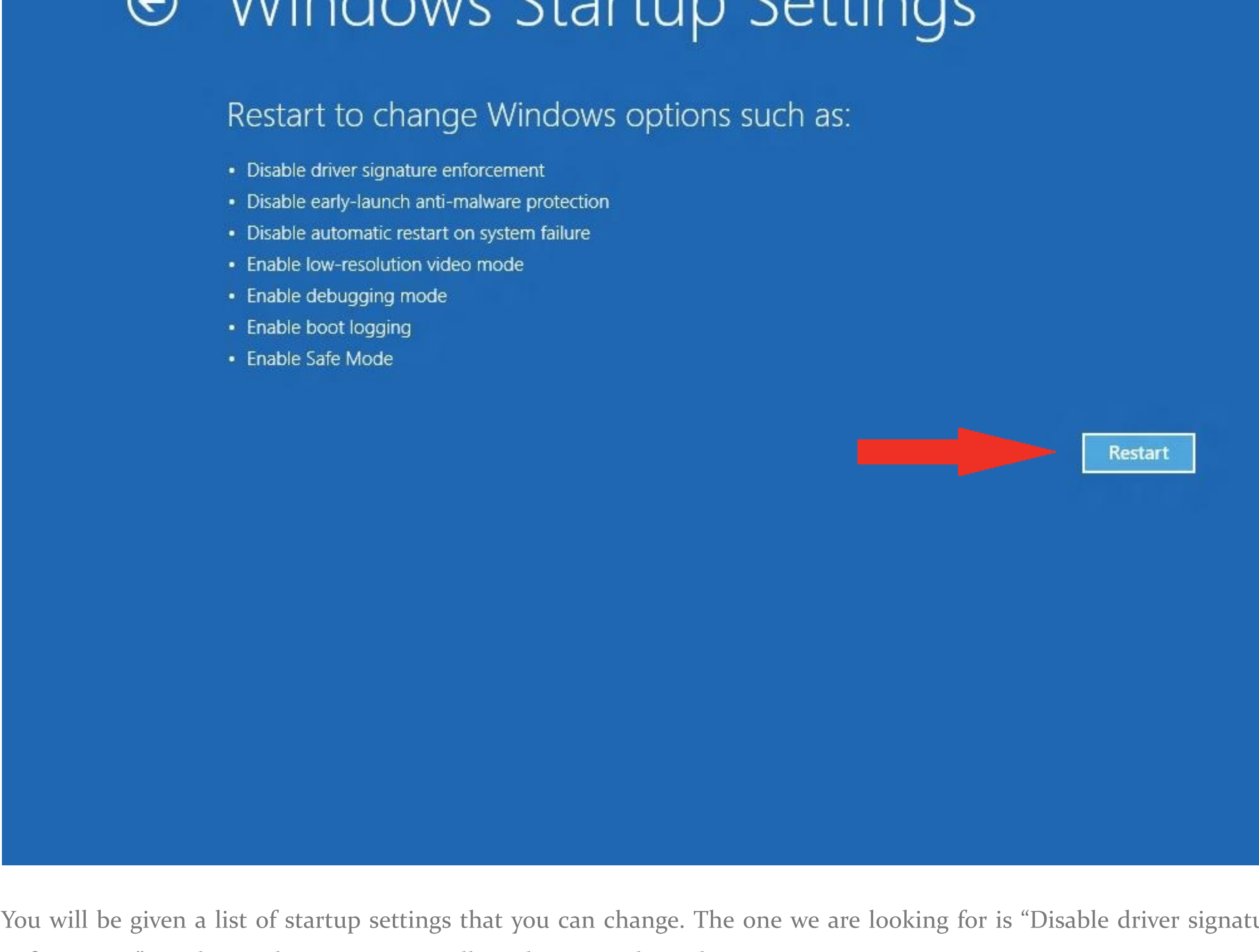

You will be given a list of startup settings that you can change. The one we are looking for is “Disable driver signature enforcement”. To choose the setting, you will need to press the F7 key:

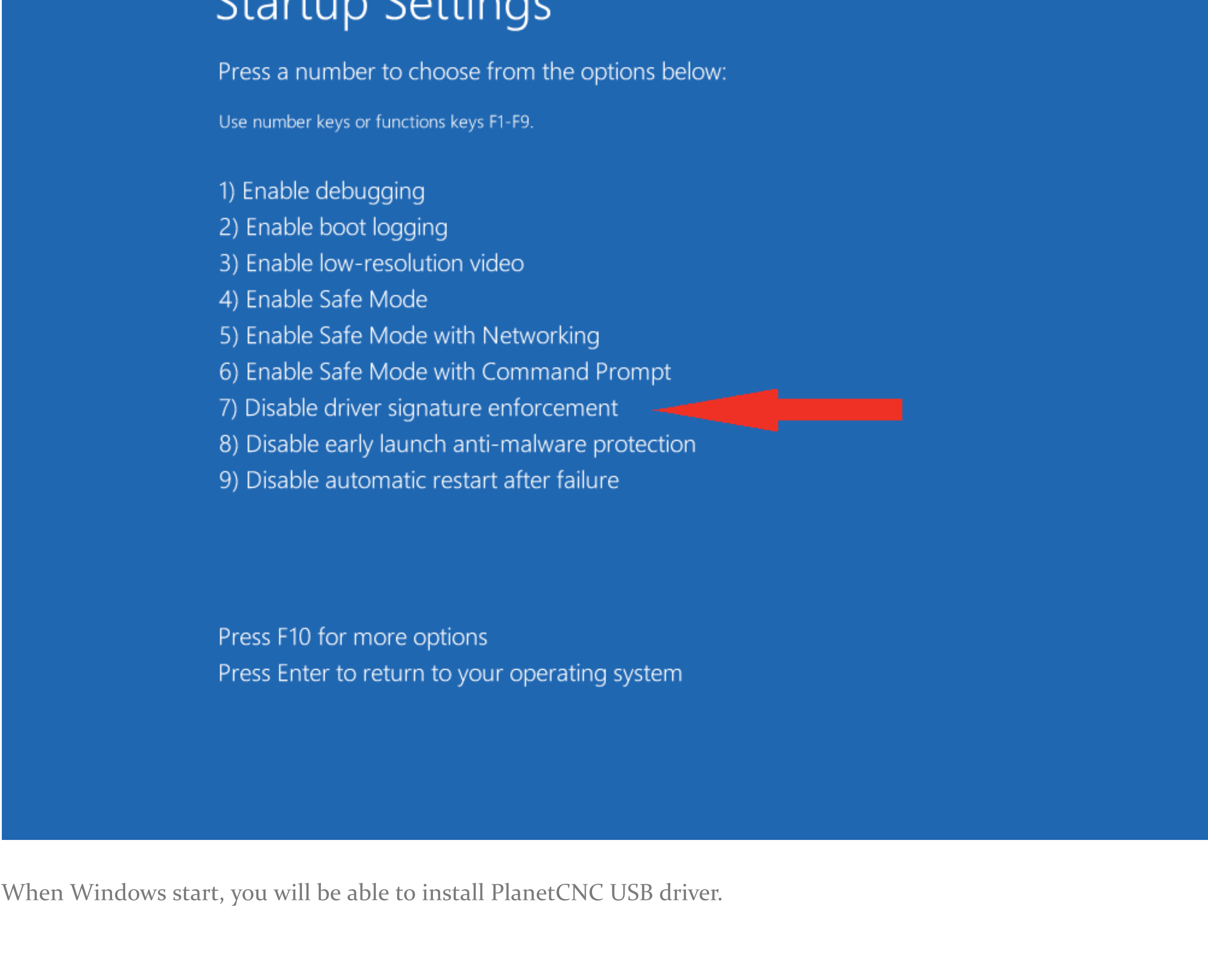

When Windows start, you will be able to install PlanetCNC USB driver.

Products

Hardware

Software

Solutions

Milling

Turning

Plasma cutting

Laser cutting

Foam cutting

3D printing

Other uses

Shop

Terms and conditions

Privacy policy

Order and delivery

Return policy

Payments:

PayPal

Bank transfer

Contact

E-mail: info@planet-cnc.com

You Tube

facebook

