

Koła zębate walcowe z piastą

zęby proste, kąt przyporu 20°

Materiał

Stal C 43

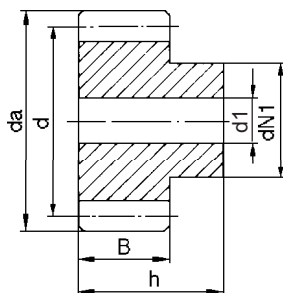
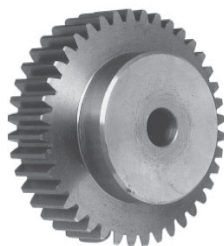

	B	h
Moduł 1	15	25
Moduł 1.5	17	30

Moduł 1

Kod	Ilość zębów	da	d	dN1	d1	Kod	Ilość zębów	da	d	dN1	d1
T 16837	12	14	12	9	-	T 43361	42	44	42	30	10
T 16838	13	15	13	10	-	T 43362	43	45	43	30	10
T 16839	14	16	14	11	-	T 43363	44	46	44	30	10
T 16840	15	17	15	12	6	T 16856	45	47	45	30	10
T 16841	16	18	16	13	6	T 43364	46	48	46	30	10
T 16842	17	19	17	14	8	T 43365	47	49	47	30	10
T 16843	18	20	18	15	8	T 16857	48	50	48	30	10
T 16844	19	21	19	15	8	T 43366	49	51	49	30	10
T 16845	20	22	20	16	8	T 16858	50	52	50	30	12
T 16846	21	23	21	16	8	T 43367	51	53	51	40	12
T 16847	22	24	22	16	8	T 16859	52	54	52	40	12
T 16848	23	25	23	18	8	T 43368	53	55	53	40	12
T 16849	24	26	24	20	10	T 43369	54	56	54	40	12
T 16850	25	27	25	20	10	T 43370	55	57	55	40	12
T 43350	26	28	26	20	10	T 16860	56	58	56	40	12
T 43351	27	29	27	20	10	T 43371	57	59	57	40	12
T 16851	28	30	28	20	10	T 43372	58	60	58	40	12
T 43352	29	31	29	20	10	T 43373	59	61	59	40	12
T 16852	30	32	30	20	10	T 16861	60	62	60	40	12
T 43353	31	33	31	25	10	T 43374	61	63	61	50	12
T 43354	32	34	32	25	10	T 43375	62	64	62	50	12
T 43355	33	35	33	25	10	T 43376	63	65	63	50	12
T 43356	34	36	34	25	10	T 43377	64	66	64	50	12
T 43357	35	37	35	25	10	T 43378	65	67	65	50	12
T 16853	36	38	36	25	10	T 43379	66	68	66	50	12
T 43358	37	39	37	25	10	T 43380	67	69	67	50	12
T 16854	38	40	38	25	10	T 43381	68	70	68	50	12
T 43359	39	41	39	25	10	T 43382	69	71	69	50	12
T 16855	40	42	40	25	10	T 43383	70	72	70	50	12
T 43360	41	43	41	30	10						

Moduł 1.5

T 16862	12	21.0	18.0	14	8	T 16873	23	37.5	34.5	25	10
T 16863	13	22.5	19.5	15	8	T 16874	24	39.0	36.0	25	10
T 16864	14	24.0	21.0	17	8	T 16875	25	40.5	37.5	25	10
T 16865	15	25.5	22.5	18	8	T 43385	26	42.0	39.0	30	12
T 16866	16	27.0	24.0	19	8	T 43386	27	43.5	40.5	30	12
T 16867	17	28.5	25.5	20	8	T 16876	28	45.0	42.0	30	12
T 16868	18	30.0	27.0	20	8	T 43387	29	46.5	43.5	30	12
T 16869	19	31.5	28.5	20	8	T 16877	30	48.0	45.0	30	12
T 16870	20	33.0	30.0	25	8	T 43388	31	49.5	46.5	35	12
T 16871	21	34.5	31.5	25	10	T 43389	32	51.0	48.0	35	12
T 16872	22	36.0	33.0	25	10	T 43390	33	52.5	49.5	35	12

Rozmiary w mm.

Koła zębate walcowe z piastą

zęby proste, kąt przyporu 20°

Materiał

Stal C 43

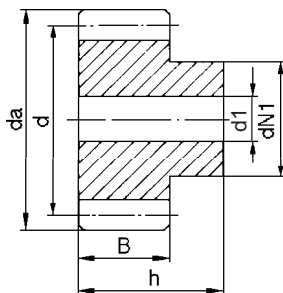
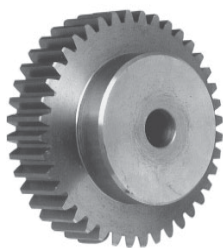

	B	h
Moduł 1.5	17	30
Moduł 2	20	35

Moduł 1.5

Kod	Ilość zębów	da	d	dN1	d1	Kod	Ilość zębów	da	d	dN1	d1
T 43391	34	54.0	51.0	35	12	T 43403	53	82.5	79.5	60	14
T 43392	35	55.5	52.5	35	12	T 43404	54	84.0	81.0	60	14
T 16878	36	57.0	54.0	35	12	T 43405	55	85.5	82.5	60	14
T 43393	37	58.5	55.5	40	12	T 16885	56	87.0	84.0	60	16
T 16879	38	60.0	57.0	40	12	T 43406	57	88.5	85.5	60	16
T 43394	39	61.5	58.5	40	12	T 43407	58	90.0	87.0	60	16
T 16880	40	63.0	60.0	40	12	T 43408	59	91.5	88.5	60	16
T 43395	41	64.5	61.5	40	12	T 16886	60	93.0	90.0	60	16
T 43396	42	66.0	63.0	50	12	T 43409	61	94.5	91.5	70	16
T 43397	43	67.5	64.5	50	12	T 43411	62	96.0	93.0	70	16
T 43398	44	69.0	66.0	50	12	T 43412	63	97.5	94.5	70	16
T 16881	45	70.5	67.5	50	12	T 43413	64	99.0	96.0	70	16
T 43399	46	72.0	69.0	50	14	T 43414	65	100.5	97.5	70	16
T 43400	47	73.5	70.5	50	14	T 43415	66	102.0	99.0	70	16
T 16882	48	75.0	72.0	50	14	T 43416	67	103.5	100.5	70	16
T 43401	49	76.5	73.5	50	14	T 43417	68	105.0	102.0	70	16
T 16883	50	78.0	75.0	50	14	T 43418	69	106.5	103.5	70	16
T 43402	51	79.5	76.5	60	14	T 43419	70	108.0	105.0	70	16
T 16884	52	81.0	78.0	60	14						

Moduł 2

T 16887	12	28	24	18	10	T 43426	34	72	68	45	14
T 16888	13	30	26	20	10	T 43427	35	74	70	45	14
T 16889	14	32	28	22	10	T 16903	36	76	72	45	14
T 16890	15	34	30	24	10	T 43428	37	78	74	50	14
T 16891	16	36	32	25	10	T 16904	38	80	76	50	14
T 16892	17	38	34	25	10	T 43429	39	82	78	50	14
T 16893	18	40	36	25	10	T 16905	40	84	80	50	14
T 16894	19	42	38	25	10	T 43430	41	86	82	55	16
T 16895	20	44	40	30	10	T 43431	42	88	84	55	16
T 16896	21	46	42	30	12	T 43432	43	90	86	55	16
T 16897	22	48	44	30	12	T 43433	44	92	88	60	16
T 16898	23	50	46	30	12	T 16906	45	94	90	60	16
T 16899	24	52	48	35	12	T 43434	46	96	92	60	16
T 16900	25	54	50	35	12	T 43435	47	98	94	70	16
T 43420	26	56	52	40	12	T 16907	48	100	96	70	16
T 43421	27	58	54	40	12	T 43436	49	102	98	70	16
T 16901	28	60	56	40	12	T 16908	50	104	100	70	16
T 43422	29	62	58	40	14	T 43437	51	106	102	70	16
T 16902	30	64	60	40	14	T 16909	52	108	104	70	16
T 43423	31	66	62	45	14	T 43438	53	110	106	70	16
T 43424	32	68	64	45	14	T 43439	54	112	108	70	16
T 43425	33	70	66	45	14	T 43440	55	114	110	70	16

Rozmiary w mm.

Koła zębate walcowe z piastą

zęby proste, kąt przyporu 20°

Materiał

Stal C 43

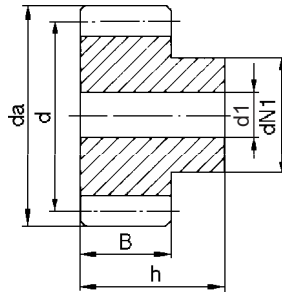
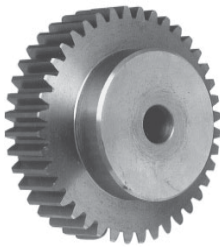

	B	h
Moduł 2	20	35
Moduł 2.5	25	45

Moduł 2

Kod	Ilość zębów	da	d	dN1	d1	Kod	Ilość zębów	da	d	dN1	d1
T 16910	56	116	112	70	16	T 43447	64	132	128	80	16
T 43441	57	118	114	70	16	T 43448	65	134	130	80	16
T 43442	58	120	116	70	16	T 43449	66	136	132	80	16
T 43443	59	122	118	70	16	T 43451	67	138	134	80	16
T 16911	60	124	120	70	16	T 43452	68	140	136	80	16
T 43444	61	126	122	80	16	T 43453	69	142	138	80	16
T 43445	62	128	124	80	16	T 43454	70	144	140	80	16
T 43446	63	130	126	80	16						

Moduł 2.5

T 16912	12	35.0	30.0	22	10	T 43463	37	97.5	92.5	60	16
T 16913	13	37.5	32.5	25	10	T 16929	38	100.0	95.0	60	16
T 16914	14	40.0	35.0	28	10	T 43464	39	102.5	97.5	60	16
T 16915	15	42.5	37.5	30	10	T 16930	40	105.0	100.0	70	16
T 16916	16	45.0	40.0	32	12	T 43465	41	107.5	102.5	70	16
T 16917	17	47.5	42.5	35	12	T 43466	42	110.0	105.0	70	16
T 16918	18	50.0	45.0	35	12	T 43467	43	112.5	107.5	70	16
T 16919	19	52.5	47.5	35	12	T 43468	44	115.0	110.0	70	16
T 16920	20	55.0	50.0	40	12	T 16931	45	117.5	112.5	70	16
T 16921	21	57.5	52.5	40	14	T 43469	46	120.0	115.0	70	20
T 16922	22	60.0	55.0	45	14	T 43470	47	122.5	117.5	80	20
T 16923	23	62.5	57.5	45	14	T 16932	48	125.0	120.0	80	20
T 16924	24	65.0	60.0	45	14	T 43471	49	127.5	122.5	80	20
T 16925	25	67.5	62.5	50	14	T 16933	50	130.0	125.0	80	20
T 43455	26	70.0	65.0	50	14	T 43472	51	132.5	127.5	80	20
T 43456	27	72.5	67.5	50	14	T 16934	52	135.0	130.0	90	20
T 16926	28	75.0	70.0	50	14	T 43473	53	137.5	132.5	90	20
T 43457	29	77.5	72.5	50	14	T 43474	54	140.0	135.0	90	20
T 16927	30	80.0	75.0	55	14	T 43475	55	142.5	137.5	90	20
T 43458	31	82.5	77.5	55	16	T 16935	56	145.0	140.0	100	20
T 43459	32	85.0	80.0	55	16	T 43476	57	147.5	142.5	100	20
T 43460	33	87.5	82.5	55	16	T 43477	58	150.0	145.0	100	20
T 43461	34	90.0	85.0	55	16	T 43478	59	152.5	147.5	100	20
T 43462	35	92.5	87.5	60	16	T 43479	60	155.0	150.0	100	20
T 16928	36	95.0	90.0	60	16						

Rozmiary w mm.

Koła zębate walcowe z piastą

zęby proste, kąt przyporu 20°

Materiał

Stal C 43

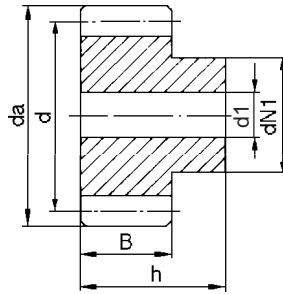

	B	h
Moduł 3	30	50
Moduł 4	40	60

Moduł 3

Kod	Ilość zębów	da	d	dN1	d1	Kod	Ilość zębów	da	d	dN1	d1
T 16936	12	42	36	27	12	T 43483	31	99	93	60	16
T 16937	13	45	39	30	12	T 43484	32	102	96	70	16
T 16938	14	48	42	35	12	T 43485	33	105	99	70	16
T 16939	15	51	45	35	12	T 43486	34	108	102	70	16
T 16940	16	54	48	38	14	T 43487	35	111	105	70	16
T 16941	17	57	51	42	14	T 16952	36	114	108	70	20
T 16942	18	60	54	45	14	T 43488	37	117	111	70	20
T 16943	19	63	57	45	14	T 16953	38	120	114	80	20
T 16944	20	66	60	45	14	T 43489	39	123	117	80	20
T 16945	21	69	63	45	16	T 16954	40	126	120	80	20
T 16946	22	72	66	50	16	T 43490	41	129	123	80	20
T 16947	23	75	69	50	16	T 43491	42	132	126	80	20
T 16948	24	78	72	50	16	T 43492	43	135	129	80	20
T 16949	25	81	75	60	16	T 43493	44	138	132	90	20
T 43480	26	84	78	60	16	T 16955	45	141	135	90	20
T 43481	27	87	81	60	16	T 43494	46	144	138	90	20
T 16950	28	90	84	60	16	T 43495	47	147	141	100	20
T 43482	29	93	87	60	16	T 16956	48	150	144	100	20
T 16951	30	96	90	60	16						

Moduł 4

T 16957	12	56	48	35	14	T 16970	25	108	100	75	20
T 16958	13	60	52	40	14	T 43496	26	112	104	75	20
T 16959	14	64	56	45	14	T 43497	27	116	108	75	20
T 16960	15	68	60	45	14	T 16971	28	120	112	75	20
T 16961	16	72	64	50	16	T 43498	29	124	116	75	20
T 16962	17	76	68	50	16	T 16972	30	128	120	75	20
T 16963	18	80	72	50	16	T 43499	31	132	124	80	20
T 16964	19	84	76	60	16	T 43500	32	136	128	80	20
T 16965	20	88	80	60	16	T 43501	33	140	132	80	20
T 16966	21	92	84	70	16	T 43502	34	144	136	80	20
T 16967	22	96	88	70	16	T 43503	35	148	140	80	20
T 16968	23	100	92	75	20	T 16973	36	152	144	80	25
T 16969	24	104	96	75	20						

Rozmiary w mm.

Koła zębate walcowe z piastą

zęby proste, kąt przyporu 20°

Materiał

Stal C 43

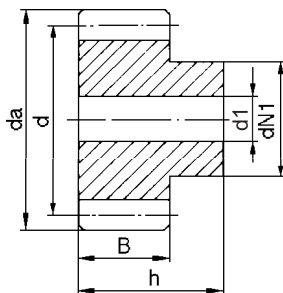

	B	h
Moduł 5	50	75
Moduł 6	60	80

Moduł 5

Kod	Ilość zębów	da	d	dN1	d1	Kod	Ilość zębów	da	d	dN1	d1
T 16974	12	70	60	45	20	T 16984	22	120	110	80	20
T 16975	13	75	65	50	20	T 16985	23	125	115	90	20
T 16976	14	80	70	55	20	T 16986	24	130	120	90	20
T 16977	15	85	75	60	20	T 16987	25	135	125	90	20
T 16978	16	90	80	65	20	T 43504	26	140	130	100	20
T 16979	17	95	85	70	20	T 43506	27	145	135	100	20
T 16980	18	100	90	70	20	T 18533	28	150	140	100	25
T 16981	19	105	95	70	20	T 43507	29	155	145	110	25
T 16982	20	110	100	80	20	T 43508	30	160	150	110	25
T 16983	21	115	105	80	20						

Moduł 6

T 16989	12	84	72	54	20	T 16995	18	120	108	80	20
T 16990	13	90	78	60	20	T 16997	20	132	120	90	20
T 16992	15	102	90	70	20	T 17001	24	156	144	110	25
T 16993	16	108	95	75	20	T 17002	25	162	150	110	25

Rozmiary w mm.

Koła zębate walcowe bez piasty

zęby proste, kąt przyporu 20°

Materiał

Stal C 43

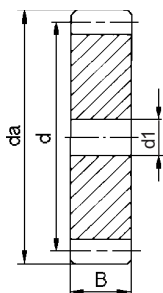
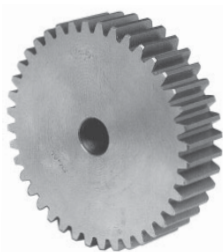

	B
Moduł 1	15
Moduł 1.5	17
Moduł 2	20
Moduł 2.5	25

Moduł 1

Kod	Ilość zębów	da	d	d1		Kod	Ilość zębów	da	d	d1
T 43509	72	74	72	12		T 17006	95	97	95	12
T 43510	75	77	75	12		T 43513	100	102	100	12
T 17004	76	78	76	12		T 43514	110	112	110	12
T 17005	80	82	80	12		T 43515	114	116	114	12
T 43511	85	87	85	12		T 43516	120	122	120	12
T 43512	90	92	90	12		T 43517	127	129	127	12

Moduł 1.5

T 43519	72	111.0	108.0	16		T 17009	95	145.5	142.5	16
T 43520	75	115.5	112.5	16		T 43524	100	153.0	150.0	16
T 17007	76	117.0	114.0	16		T 43525	110	168.0	165.0	16
T 17008	80	123.0	120.0	16		T 43526	114	174.0	171.0	16
T 43522	85	130.5	127.5	16		T 43527	120	183.0	180.0	16
T 43523	90	138.0	135.0	16		T 43528	127	193.5	190.5	16

Moduł 2

T 43530	72	148	144	16		T 17012	95	194	190	20
T 43531	75	154	150	20		T 43534	100	204	200	20
T 17010	76	156	152	20		T 43535	110	224	220	20
T 17011	80	164	160	20		T 43536	114	232	228	20
T 43532	85	174	170	20		T 43537	120	244	240	20
T 43533	90	184	180	20		T 43538	127	258	254	20

Moduł 2.5

T 43539	65	167.5	162.5	20		T 43544	90	230.0	225.0	25
T 43540	70	180.0	175.0	20		T 17016	95	242.5	237.5	25
T 43541	72	185.0	180.0	20		T 43545	100	255.0	250.0	25
T 43542	75	192.5	187.5	20		T 43546	110	280.0	275.0	25
T 17014	76	195.0	190.0	20		T 43552	114	290.0	285.0	25
T 17015	80	205.0	200.0	25		T 43553	120	305.0	300.0	25
T 43543	85	217.5	212.5	25		T 43554	127	322.5	317.5	25

Rozmiary w mm.

Koła zębate walcowe bez piasty

zęby proste, kąt przyporu 20°

Materiał

Stal C 43

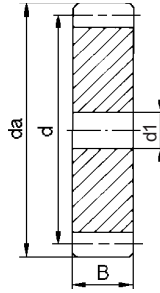
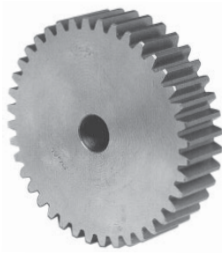

	B
Moduł 3	30
Moduł 4	40
Moduł 5	50
Moduł 6	60

Moduł 3

Kod	Ilość zębów	da	d	d1	Kod	Ilość zębów	da	d	d1
T 17017	50	156	150	20	T 17022	80	246	240	25
T 17018	52	162	156	20	T 43561	85	261	255	25
T 43555	55	171	165	20	T 43562	90	276	270	25
T 43556	57	177	171	20	T 17023	95	291	285	25
T 17020	60	186	180	20	T 43563	100	306	300	25
T 43557	65	201	195	20	T 43564	110	336	330	25
T 43558	70	216	210	25	T 43565	114	348	342	30
T 43559	72	222	216	25	T 43566	120	366	360	30
T 43560	75	231	225	25	T 43567	127	387	381	30
T 17021	76	234	228	25					

Moduł 4

T 17024	38	160	152	25	T 43572	70	288	280	25
T 17025	40	168	160	25	T 43574	75	308	300	25
T 17026	45	188	180	25	T 17032	76	312	304	30
T 17027	48	200	192	25	T 17033	80	328	320	30
T 17028	50	208	200	25	T 43575	85	348	340	30
T 17029	52	216	208	25	T 43577	90	368	360	30
T 43568	55	228	220	25	T 17034	95	388	380	30
T 43569	57	236	228	25	T 43578	100	408	400	30
T 17031	60	248	240	25	T 43579	110	448	440	30
T 43570	65	268	260	25	T 43580	114	464	456	30

Moduł 5

T 43581	32	170	160	25	T 43586	65	335	325	30
T 43582	35	185	175	25	T 43587	70	360	350	30
T 17038	38	200	190	25	T 43589	75	385	375	30
T 17039	40	210	200	25	T 17046	76	390	380	30
T 17040	45	235	225	25	T 17047	80	410	400	30
T 17041	48	250	240	25	T 43590	85	435	425	30
T 17042	50	260	250	30	T 43591	90	460	450	30
T 17043	52	270	260	30	T 17048	95	485	475	30
T 43584	55	285	275	30	T 43593	100	510	500	30
T 43585	57	295	285	30	T 43594	110	560	550	30
T 17045	60	310	300	30	T 43595	114	580	570	30

Moduł 6

T 17049	28	180	168	25	T 43598	35	222	210	25
T 17050	30	192	180	25	T 17052	38	240	220	25
T 43597	32	204	192	25	T 17053	40	252	240	25

Rozmiary w mm.